



Talas Municipality

**TOŁ CHURCH
ART GALLERY**



TOL CHURCH ART GALLERY

The history of the settlements in the region known as Cappadocia, which includes the volcanic region and its surroundings between Erciyes and Hasan Mountain, and which we are included around Erciyes, dates back to prehistoric times.

Talas is one of the important settlement areas of the early periods when Christianity spread in the Cappadocia region. Since rocky slopes and valleys were preferred more for settlement in these periods, Talas was considered as a settlement suitable for this style.

Communities with different beliefs and cultures lived together in Talas for many years. Since the Seljuk Period, Muslims and Turks have also been involved in these processes.



It should be underlined that the travelers who came to the region in the 19th century used the term "Cappadocia's Palace" when describing Talas.

Talas has a settlement history of more than 2000 years. Life continues in our historical city.

Talas was established and developed towards the surroundings and foothills of Mount Ali. The first settlement activities in the establishment process of the city coincide with the first years of the milestone, namely the Late Roman-Early Byzantine Period.

Tol Church Survey

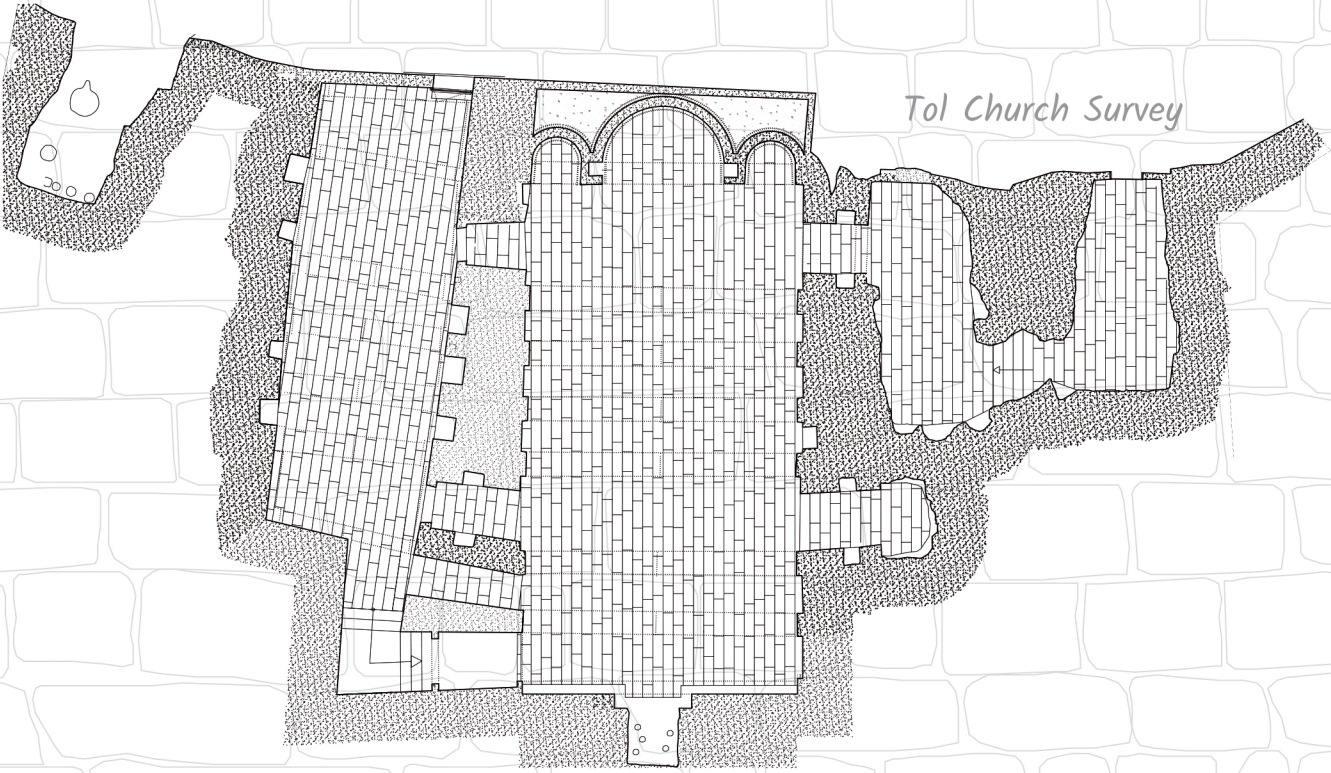

Due to its geographical location, our historical city has witnessed many cultures and civilizations that have established dominance in this geography. On this occasion, Talas has a significant amount of cultural heritage value with different qualities belonging to these civilizations. The historical and cultural heritage of our city has emerged as the common value of people who have lived in the region as members of different civilizations.

The most characteristic feature of Talas, whose traces we can easily see in the traditional life culture, is tolerance. This work,

which has survived to the present day as the work of the tolerant understanding here, has a history of approximately 1500 years.

Tol Church is one of our important cultural heritage values in our historical city. Tol is expressed as an arched space in local terms.

In the main space of the church, one of the highest arches reflecting this architectural style can be seen with a height of 6.50 m. In the church, there are two carved rock spaces along with two spaces in the form of tol.

Today, the outer area, where the walking paths are located, actually had a completely rocky structure. However, with the deformation that occurred over time, a significant part of the carved rock area in this area has disappeared. Restoration practices of the part of the building that has survived to the present day were carried out by our municipality.

With the arrangements made in 2020, this work was given the function of "Art Gallery" and the cultural life of the city was enriched even more.



Narthex (Entrance)

It is the entrance part of the building. It is one of the arched places. In addition, there are cabinet niches in the interstices, which were made alternately indented and protruding. There are three passage halls that provide access to the main space from this section

and the stairs that provide the passage to the gallery (gathering-place) section are located in this section.



Naos (Main Space)

It is the main space in the center of the building. The highest point in the space, which is made up of arches, is 6.50 m. Apses are located in this section. In this section, there are cabinet niches between the indented arches. Although this section has a connection with other spaces, the only connection that provides access to the rock-carved spaces is in this section. There is a gallery (gathering-place) floor in the area opposite the apses.



Rock Carved Spaces

They are places that are not strengthened with arches and were created only as rock carvings. It shows great similarities with the traditional elements of the settlement. It has been created as auxiliary spaces within the building and has connections with each other.





*Tol Church Art Gallery
Kıçıköy Neighborhood Ali Saip Paşa Avenue
Harmanlar Street No.9-1*



*Talas Municipality
Yenidoğan Avenue Pazar Street
No.10 38280 Talas | KAYSERİ
Tel 0(352) 437 00 54 - 55 • 0(352) 437 15 00
Fax 0(352) 437 22 21 • 0(352) 437 00 40
talas@talas.bel.tr • www.talas.bel.tr*